

- RG1710 waterproof connector
- Description:RG1710 assembly waterproof connector mate with RG1711/RG1712/RG1713



RG1710/P _ _ N

RG1710/S _ _ N

Male contact

I: solder II: crimp
Number of contact
Female contact

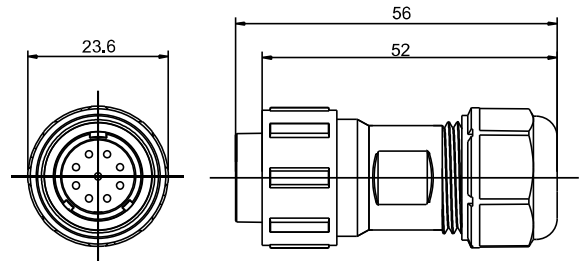

Cable outer diameter range:6-10mm

- RG1711 waterproof connector
- Description:RG1711 assembly waterproof connector mate with RG1710/RG1716



RG1711/P _ _ C

RG1711/S _ _ C

I: solder II: crimp
Number of contact

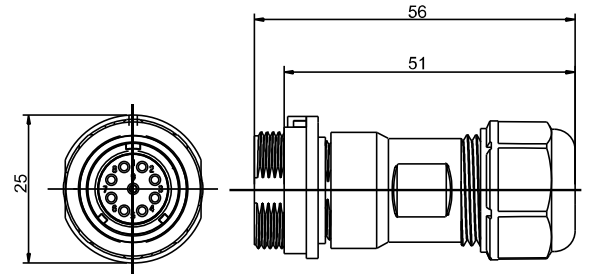

Cable outer diameter range:6-10mm

- RG1712 waterproof rear panel mount connector
- Description:RG1712 waterproof rear panel mount connector mate with RG1710/RG1716



RG1712/P _ _ C

RG1712/S _ _ C

I: solder II: crimp
Number of contact

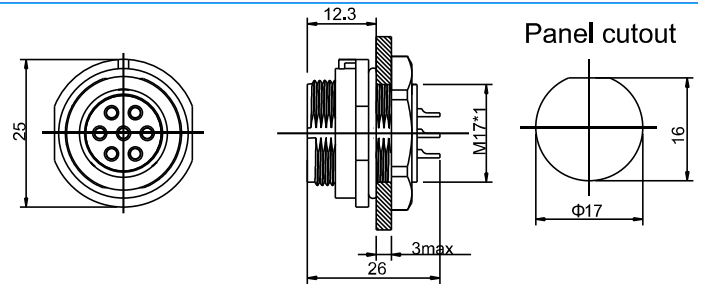

Panel cutout

- RG1713 waterproof 2-hole flange connector
- Description:RG1713 waterproof 2-hole flange connector mate with RG1710/RG1716



RG1713/P _ _ C

RG1713/S _ _ C

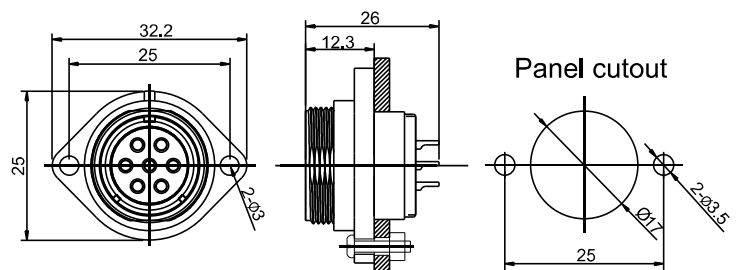

Panel cutout